

Circles

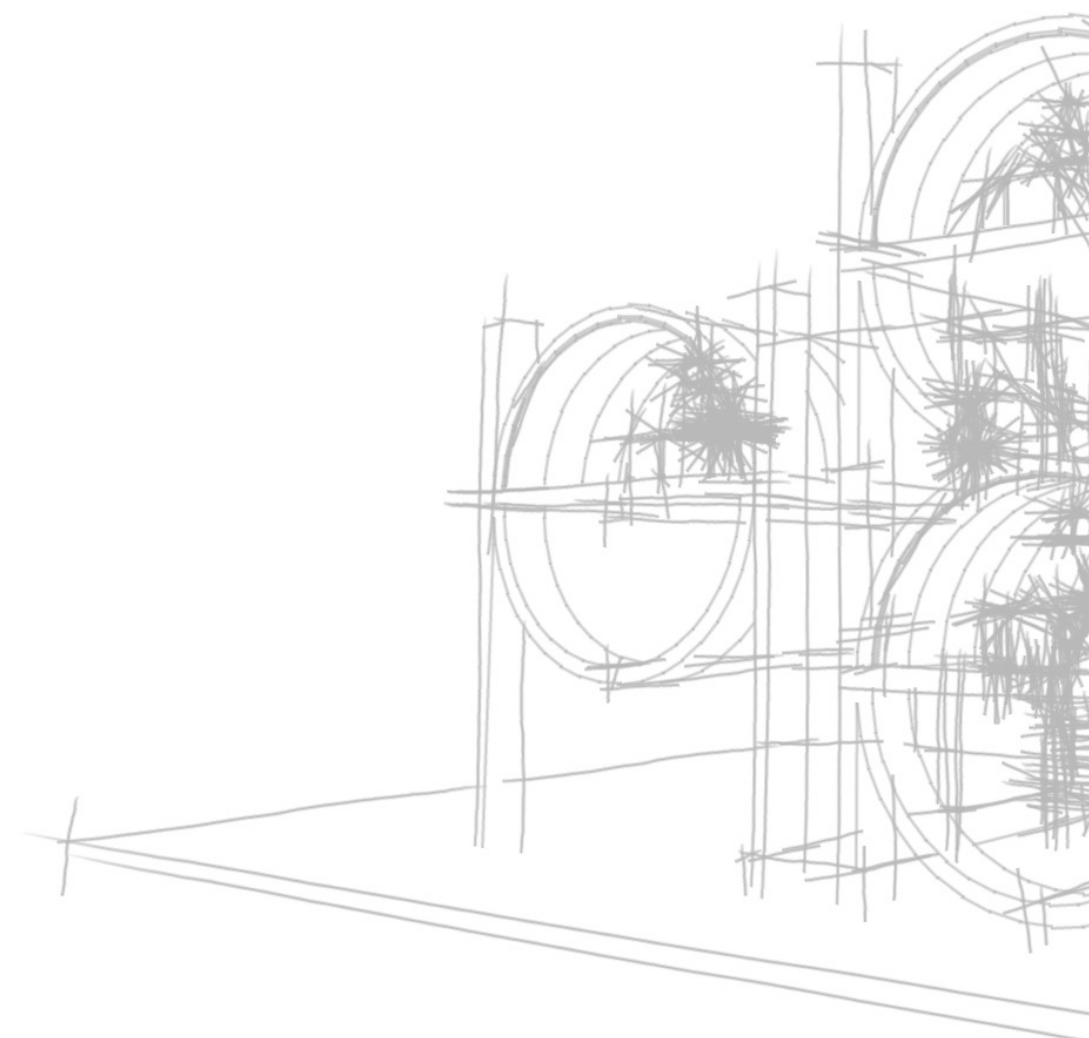



Introduction

As part of a series of collaboration briefs with Jack Dooley we decided to work on a project based entirely around circles. Jack has been working on the architectural spaces, whilst I have been designing the interior fabrics, wall coverings and decorative art.

We chose to work on circles as this is a shape that can work across both subject areas- architecture and graphic design. It was also important that we kept it quite simplistic in order for us both to have plenty of freedom to express our own individual styles and not be too restricted by complicated patterns.

It started with a lot of research; photographing circle patterns and shapes around myself. The Yorkshire Sculpture Park was of great inspiration to me, from the circles within nature to the extravagant sculptures dotted around the scenery. I love the fact that the same kind of patterns appear both in nature and man made aspects, for this reason I have tried to use different media and styles yet following similar shapes in my patterns. This then gives a wider variety, as the building I am decorating is quite small and I didn't want it to look too repetitive. However it still flows, with the same theme and colour range (red combined with black and white).

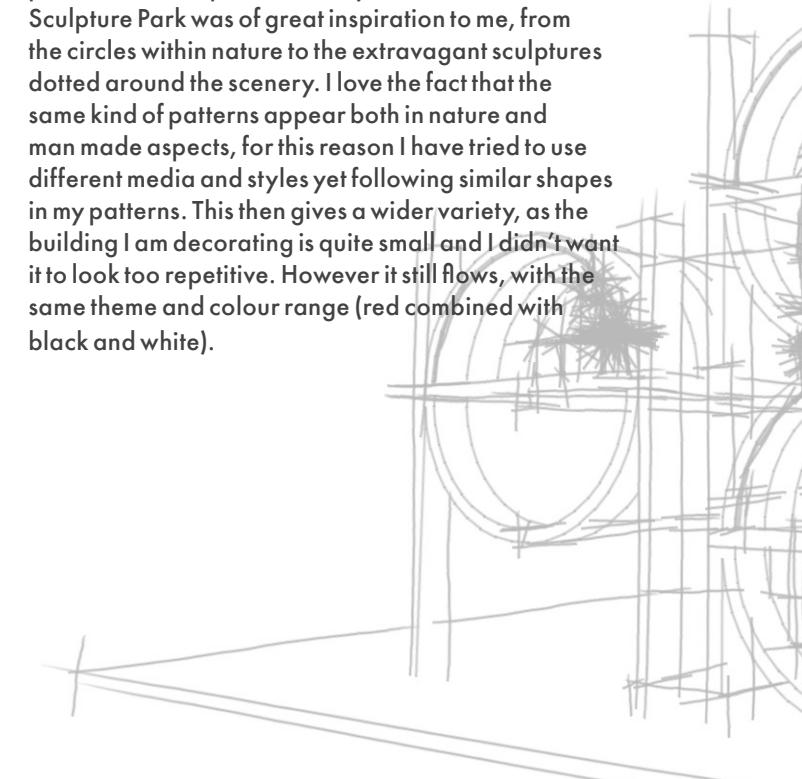



Once I had seen Jack's designs I knew it was important that particularly for the kitchen/living area I had to use a contemporary style in my own work. I like the fact that he uses statement pieces to centre the room around; like this kitchen island, this is a very modern approach and I have used it to influence my own designs.

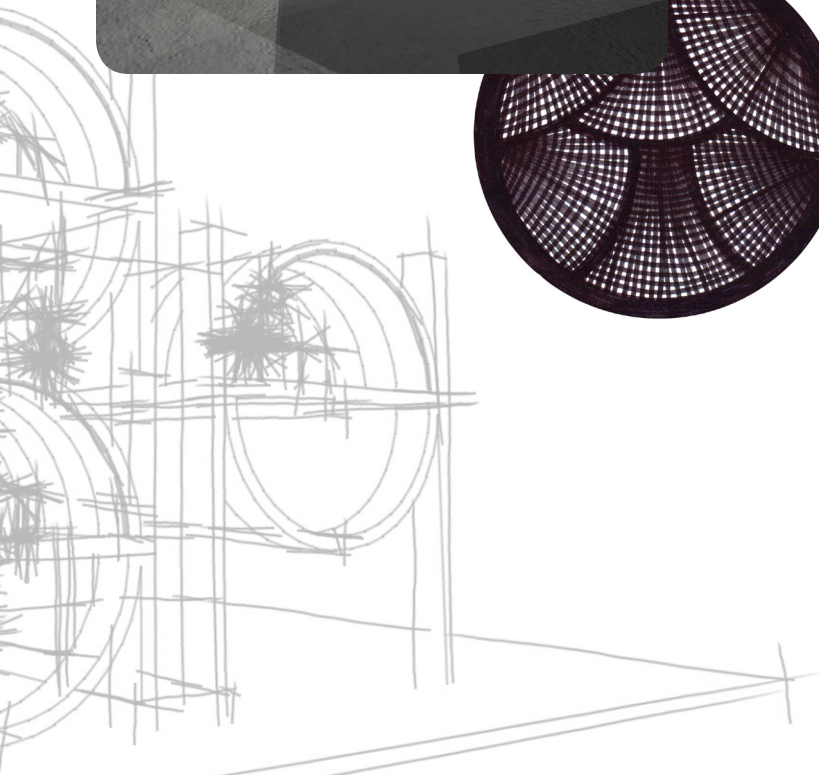
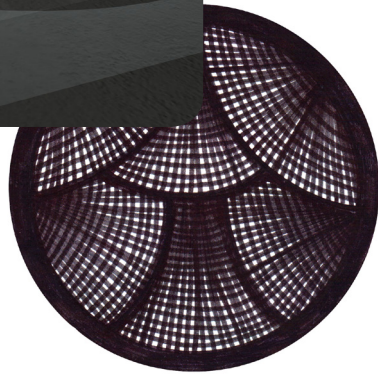



I love the imperfect circles created within nature, this inspired a range of wallpaper designs. I have used paint in a very simplistic expressive style, combined with very subtle shades of grey and white. I feel that this works well with the shape of the building, due to the minimalist approach used.

Furthermore, I have noticed that circles tend to come in groups, like the rings inside this tree stump. This has been of further inspiration for me as I like the idea of repetition within patternwork, it is perfect for interiors.

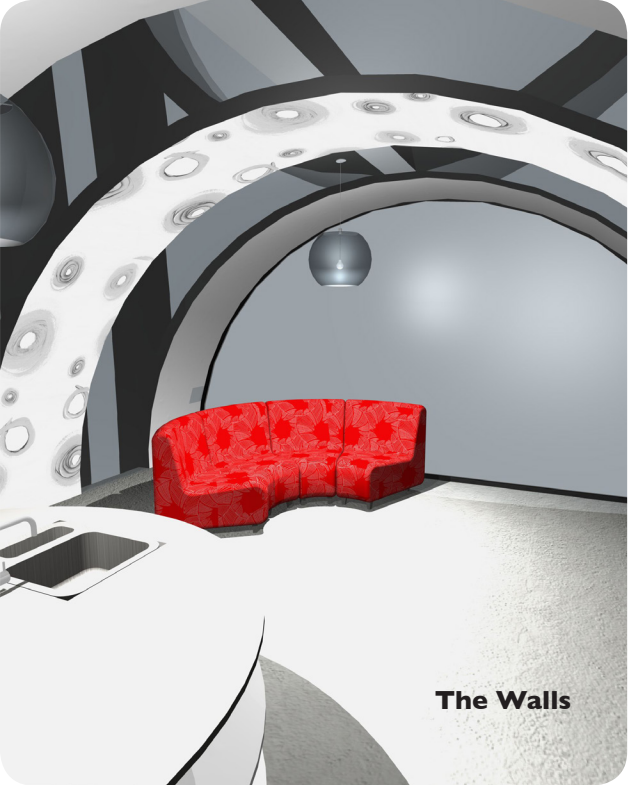

The Walls

‘I have kept the interior of this design clean cut, in order to draw the main focus to the structural elements of the building, as I want this to be the point of interest.’

Jack Dooley

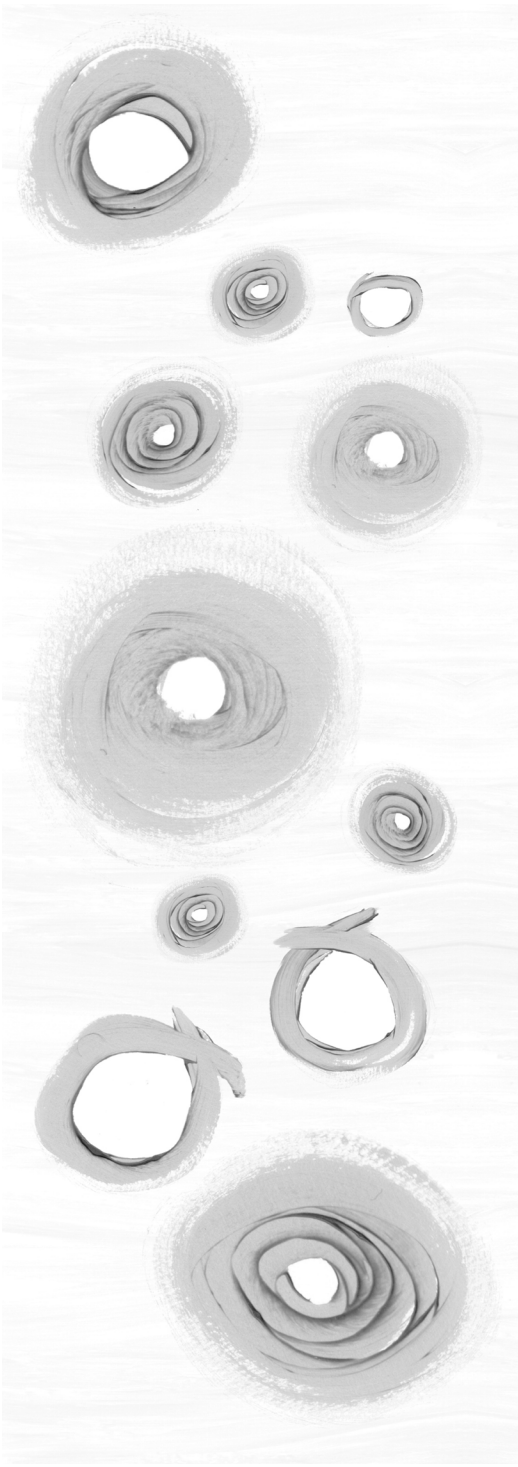

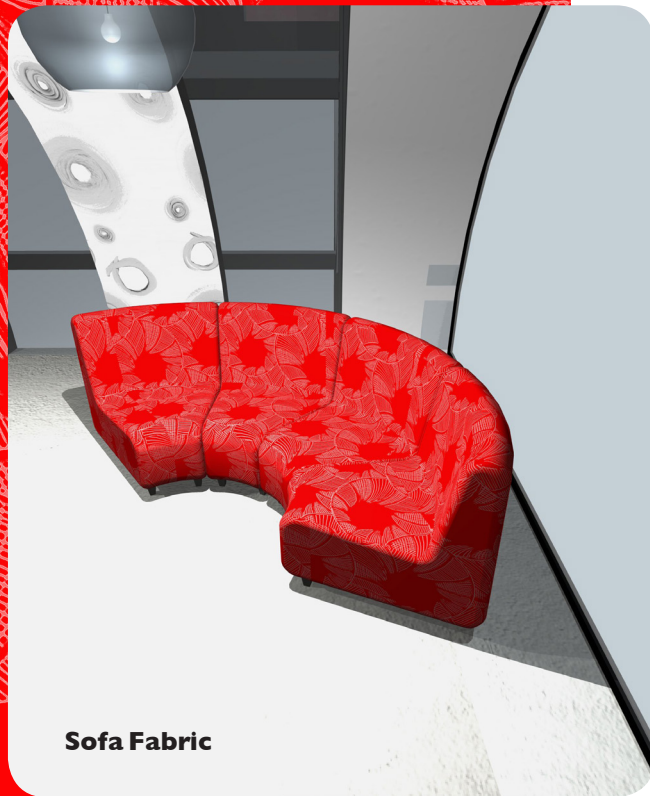

Sofa Fabric

In contrast to the designs I have used for the walls and beds etc. I chose to do a very subtle piece for the sofa fabric. I spent quite a lot of time experimenting with different shapes and patterns, however I soon realised the colours were the main issue.

Me and Jack discussed the fact that we both wanted the sofa to be another statement piece, with the unusual curved shape and vibrant red shade. This then led me to a quite detailed pattern, however with only a very subtle change in colour, making it more tasteful as you have to focus on it to see the details. I also like the fact that it almost looks like the grain in the fabric.

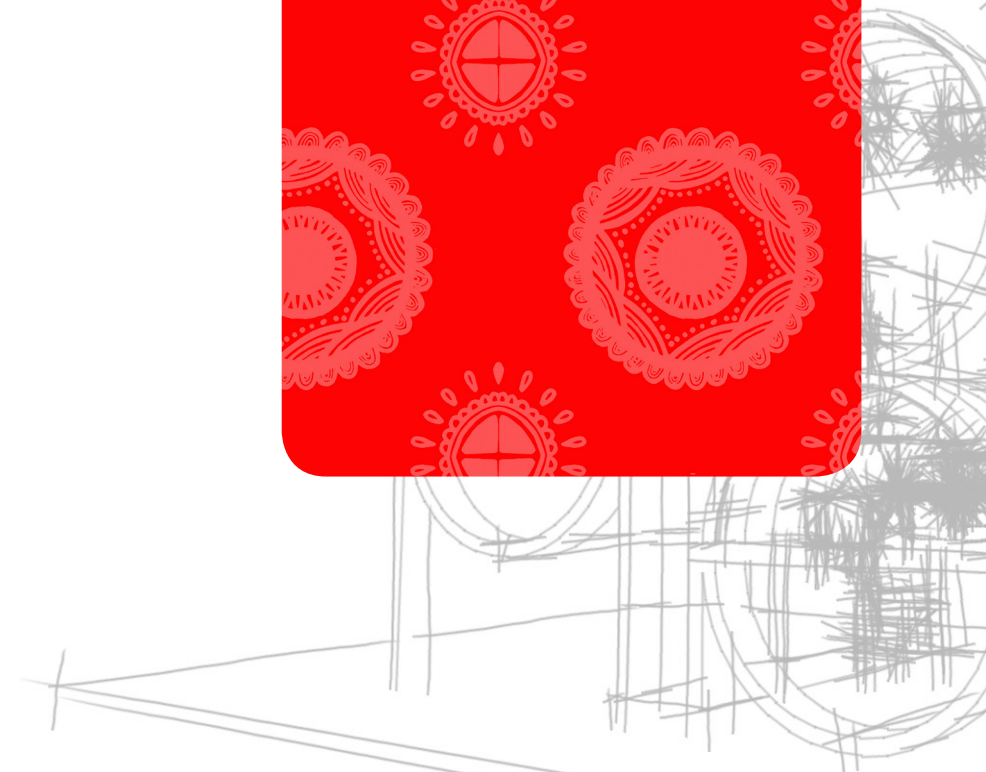
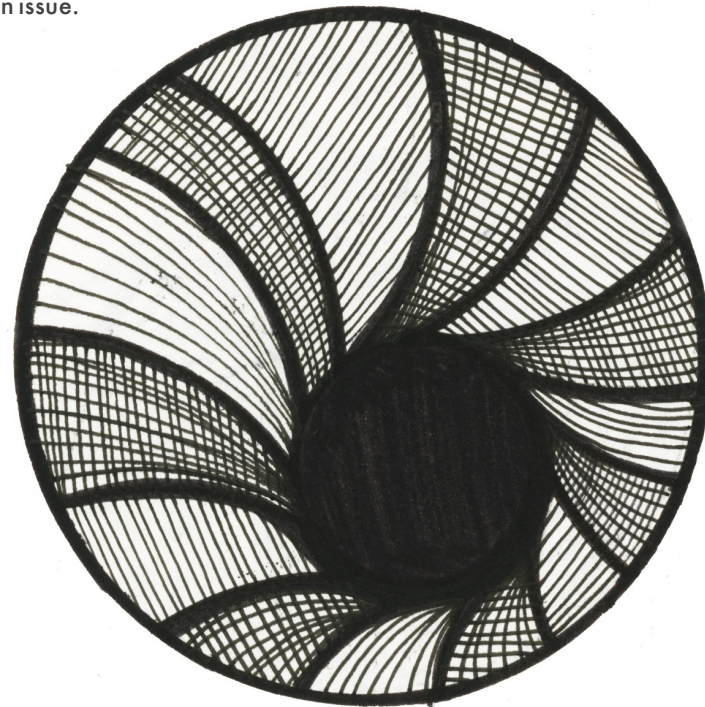

Back View

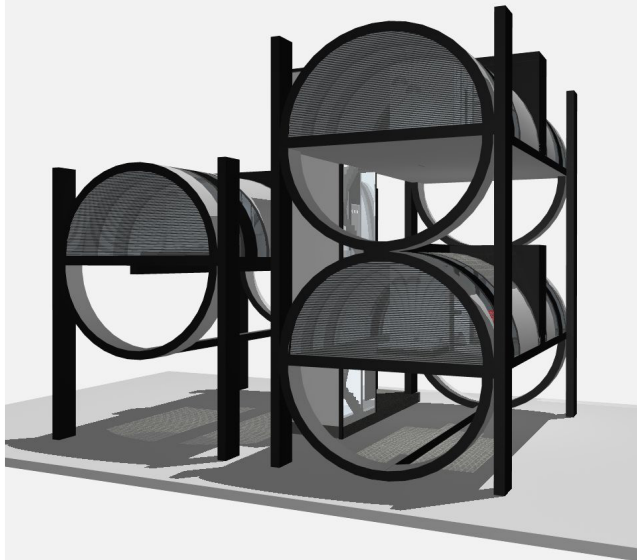

Side View

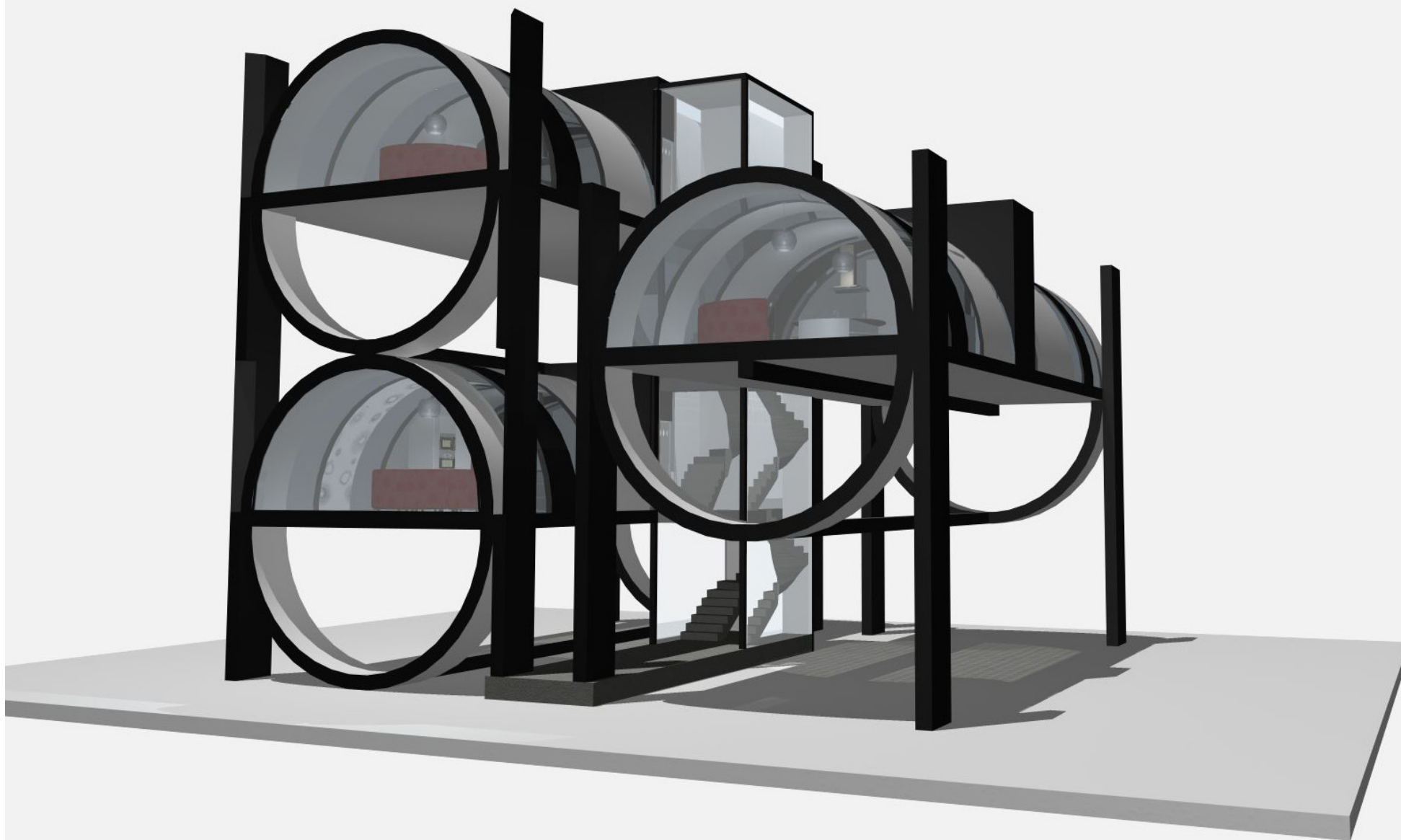
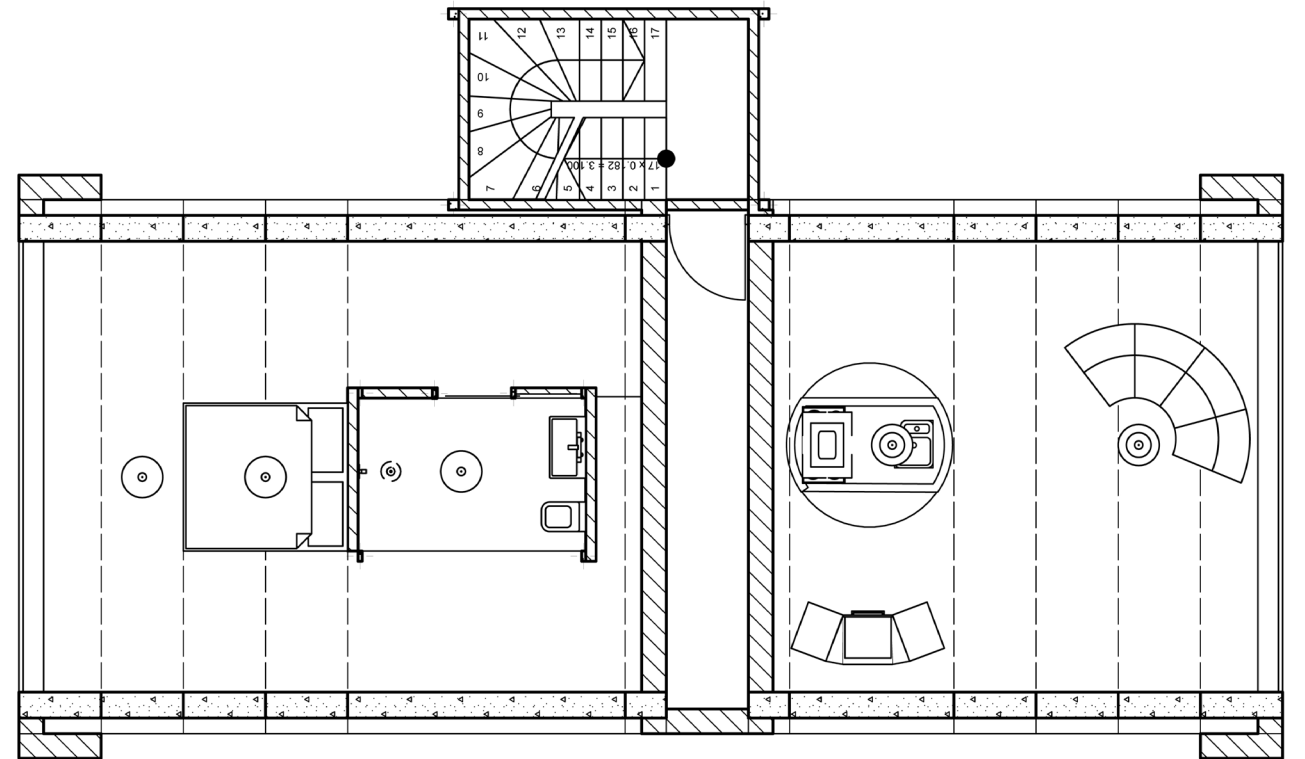
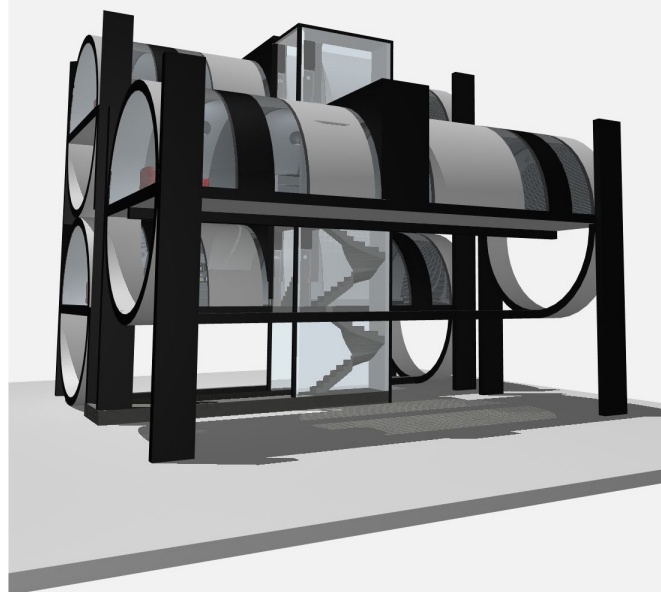

The Exterior

'Initially the concept of designing this building based around circles was slightly daunting and a bit of a challenge for me. As a designer circles as a theme or element is something I have never approached before. Nonetheless I tackled this task head on, and despite the challenge I am pleased with the overall outcome.'

The building itself is built up of three single bedroom dwellings, each of which are encased within a circular structure. I chose to have the element of circles as the main structure in order to move away from traditional circular designs within architecture. The final product stays true to my own personal style, yet has an element of originality that was required for this brief; standing out from the rest of my portfolio.'

Jack Dooley

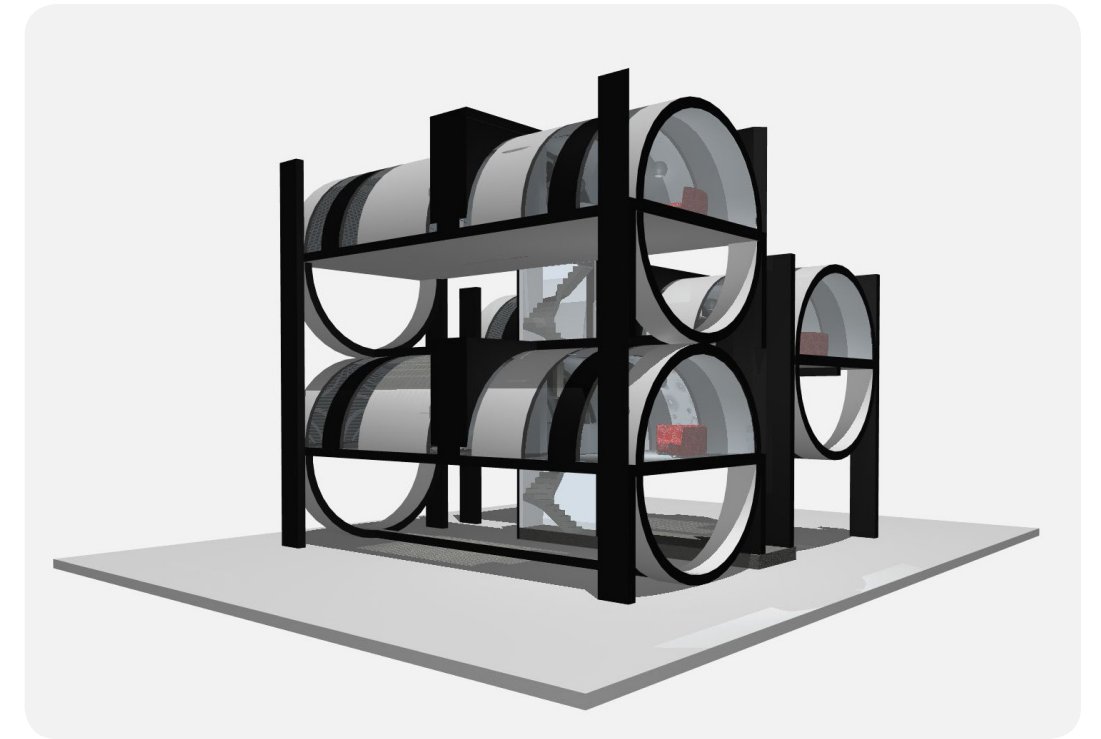
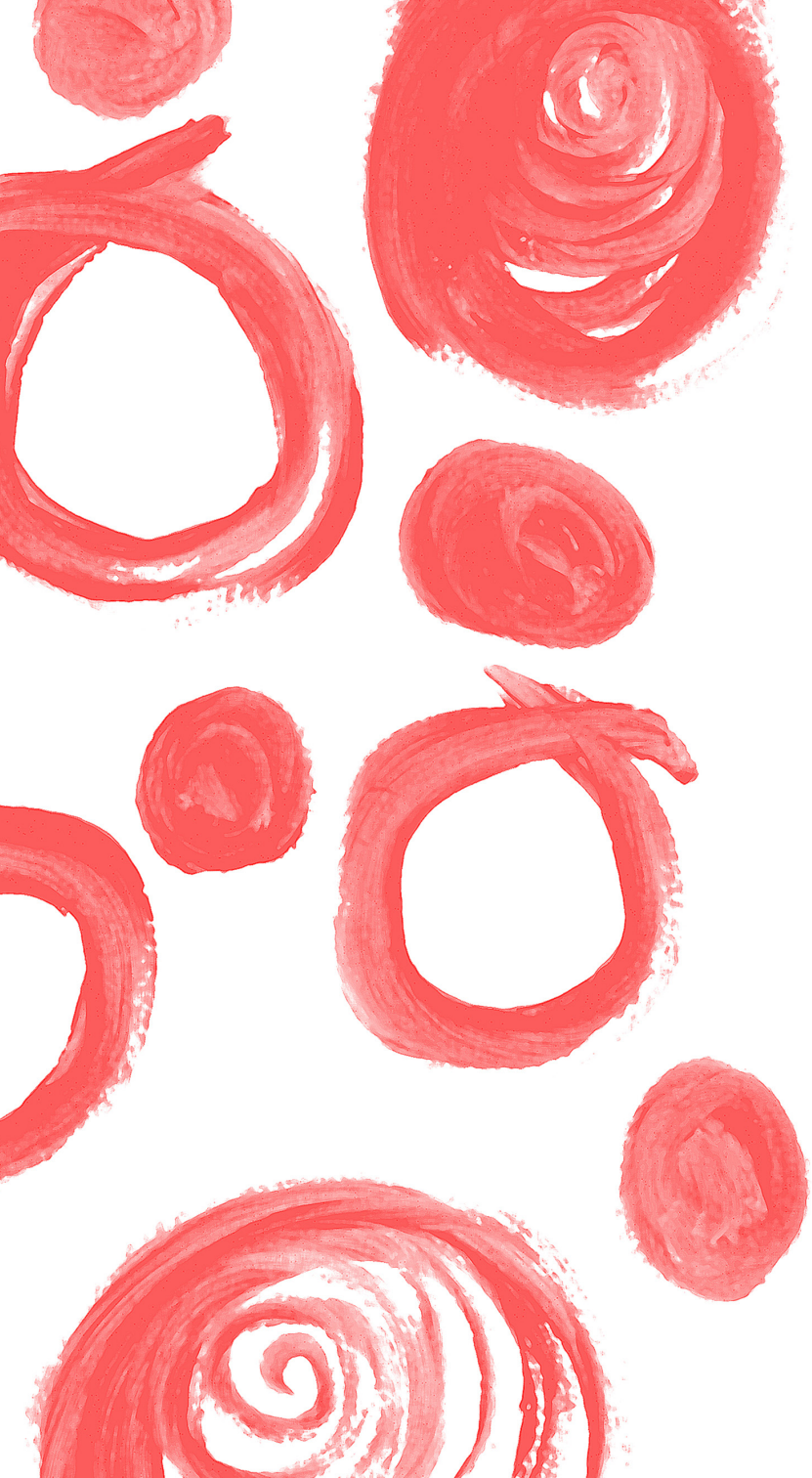

I love Jack's design, it is almost futuristic, due to the modern structure, shapes and originality. I like the fact that Jack is very minimalist in his work, which is quite a contrast to my more detailed and expressive designs.

I think this contrast brings out the best in both our work, as they enhance each other. Furthermore the overall shape of the complex has been a major influence in my designs. From the use of repetition to the compositions (circles piled up).

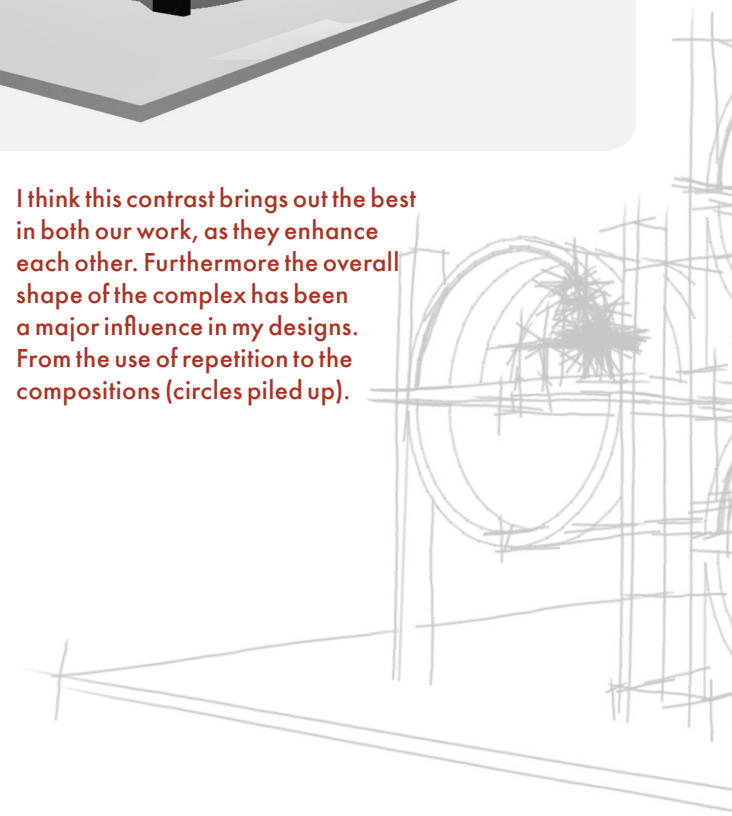



Initially for the bathroom Jack wanted a full circle shaped shower in the centre of the room, almost like a tube. Which led me to this tile idea, in which I was trying to represent the shape of the shower with the bubbles and foam etc. in the middle.

I think this could have worked nicely however it is probably a bit too busy and we decided as there was a similar format in the kitchen (the round kitchen island) it was best to alter the bathroom arrangement.

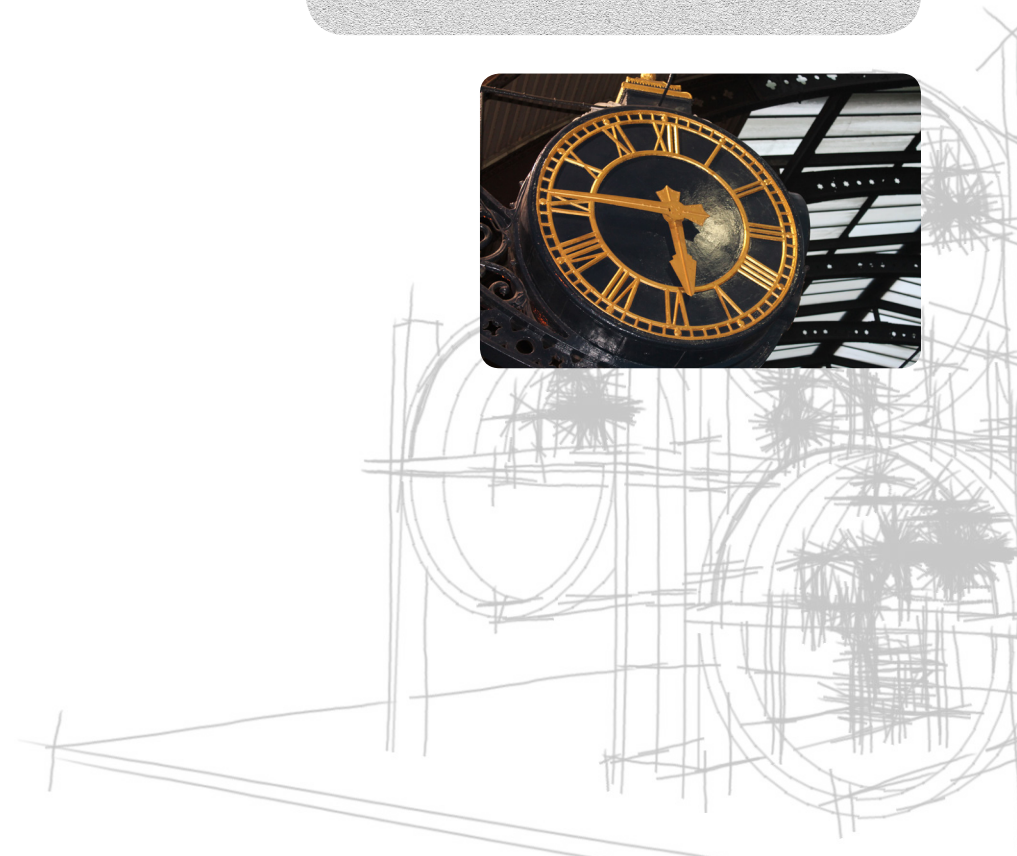

Originally we wanted a tiled bathroom, so I created a range of different possible tiles, all of which I developed in grey and white as I feel bathrooms should only add colour in accessories, and keep the walls very clean and simple.

I like some of the tile designs I came up with but when we added them to Jack's designs they looked too complicated. I would have liked it to be all white tiles with only the odd few as my designs so that they stand out. However we eventually came up with the idea to use a tile design as the full back wall of the shower, which I think was the most successful plan, as it my design is now the focal point.



The Bathroom



In the bedroom I have used a very different approach to the other rooms. I decided that I wanted a slightly contrasting style, as the rooms haven't got a full wall divide therefore the designs reflect the movement from one area to another.

Rather than painting I decided I still wanted a repetitive pattern, but with a hand drawn, more detailed look. I also wanted it to be modern but with a slight vintage twist, something which I think works really in the bedroom.

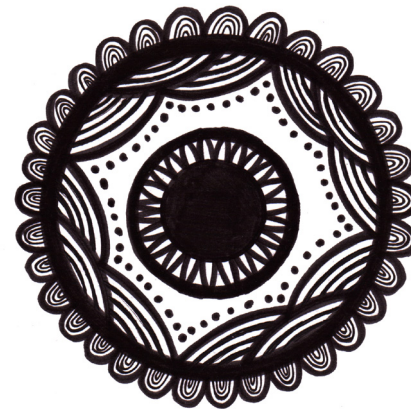
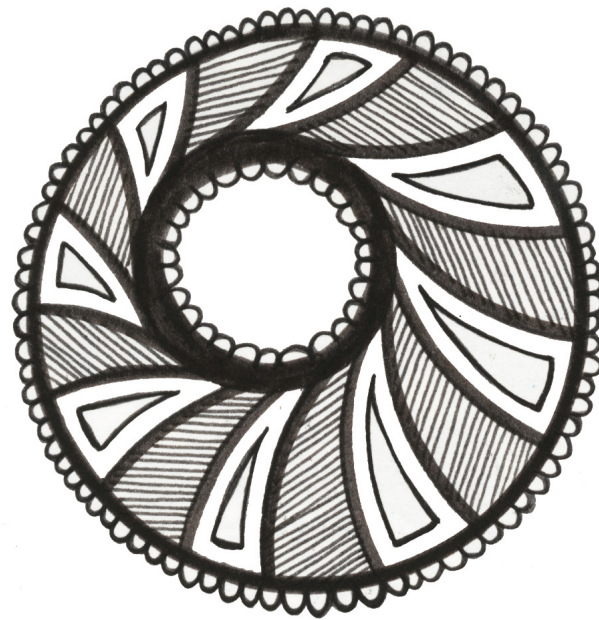

The Bedroom

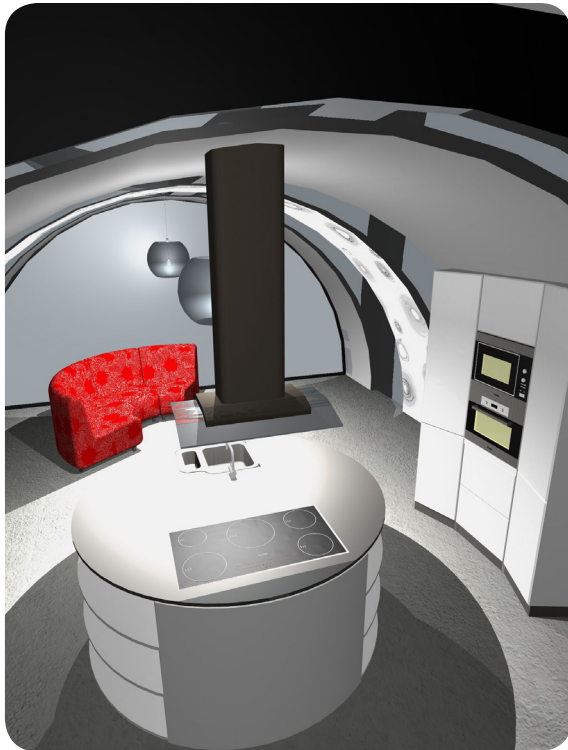

Conclusion

I think this has been quite a successful project, and I am pleased with the overall outcome. However it took a while to make progress, as I think in the beginning I was too focused on small sketches, when really a much more experimental and expressive approach was needed. Although, once I had begun to develop my style and technique it all came together nicely.

I believe I have kept to my plan of keeping a lot of variety within my designs, using a mixed media approach. Personally I prefer the more expressive painted prints, as they are much more effective. They are simplistic yet striking.

This project has been very experimental, and as it is one of the first times I have been working with interiors I have been learning as I go along. I think I have started to develop an interesting style, and hopefully this will improve and develop further throughout this series of collaborations with Jack Dooley.



